

## SCHEMA TECNICA

### COPERCHIO PEDONALE E CARRABILE DN 165

MANUFATTI IN CEMENTO VIBRATO



NORMA DI RIFERIMENTO UNI EN 1917:2004

vista frontale  
scala 1:20

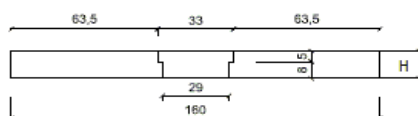

vista laterale  
scala 1:20

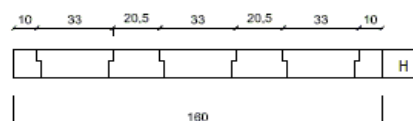

Planta  
scala 1:20

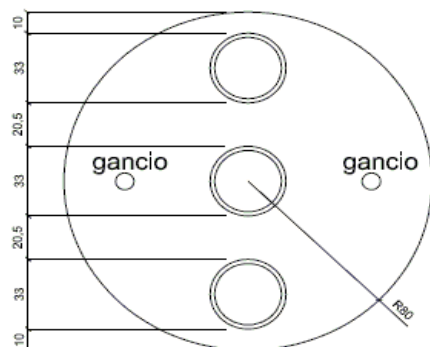

vista 3D

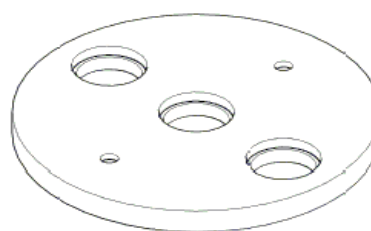

Coperchi normali dn160

#### CARATTERISTICHE IMBALLO

QUANTITA' PER BANCALE

SFUSO

#### DATI TECNICI

TIPO	DN	H	ISPEZIONI			PESO KG
PEDONALE	165	12	33	33	33	530
CARRABILE	165	18	33	33	33	780

CLASSE DI RESISTENZA CALCESTRUZZO

N/mm<sup>2</sup>

**C32/40**

SCHEDA N. COP165

DATA 03/04/2018

MOD. S823M

REVISIONE

N° 1 DEL 20/01/2020

**F.LLI VACIS srl** Via Dante Alighieri, 13 24050 COVO BG

Tel 036393167 Fax 0363938688

www.vacissrl.it - info: vacissrl@vacissrl.it