

SCHEMA TECNICA

POZZETTO 23X23 INTERNO 30X30 ESTERNO H30

POZZETTI IN CEMENTO VIBRATO



NORMA DI RIFERIMENTO UNI EN 1917:2004

vista frontale - scala 1:10

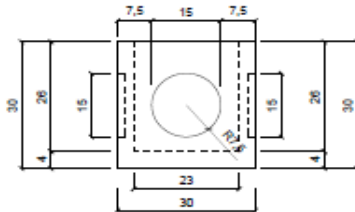

vista laterale - scala 1:10

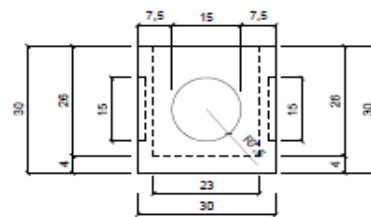

Pianta - scala 1:10

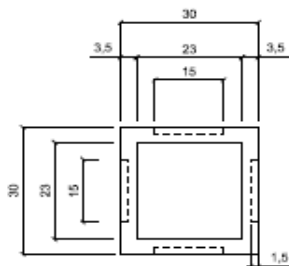

vista 3D

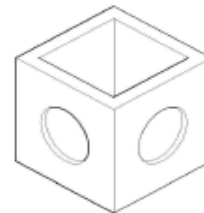

Pozzetto 30 x 30

CARATTERISTICHE IMBALLO

QUANTITA' PER BANCALE

27

DATI TECNICI

PESO

KG

27

CLASSE DI RESISTENZA CALCESTRUZZO

N/mm²

C32/40

SCHEDA N. POZ23

DATA 29/12/2011

MOD. S823M

REVISIONE

N° 1 DEL 07/12/2020

F.LLI VACIS srl Via Dante Alighieri, 13 24050 COVO BG

Tel 036393167 Fax 0363938688

www.vacissrl.it - info: vacissrl@vacissrl.it