

# SCHEDA TECNICA

## POZZETTO 31X31 INTERNO 37X37 ESTERNO H30



POZZETTI IN CEMENTO VIBRATO



NORMA DI RIFERIMENTO UNI EN 1917:2004

vista frontale - scala 1:10

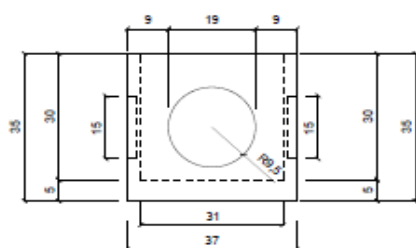

vista laterale - scala 1:10

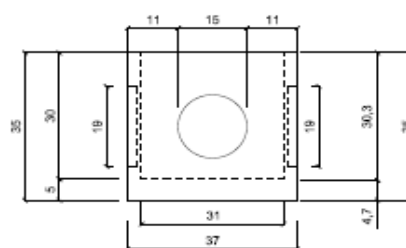

Pianta - scala 1:10

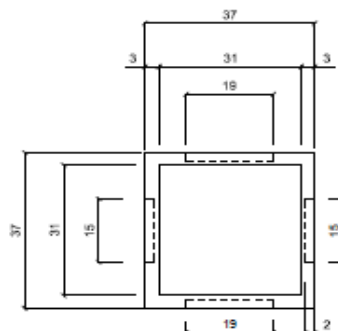

vista 3D

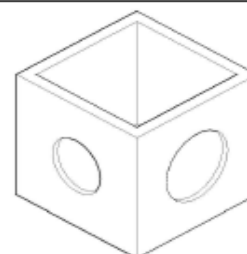

Pozzetto 37 x 37

### CARATTERISTICHE IMBALLO

QUANTITA' PER BANCALE

27

### DATI TECNICI

PESO

KG

40

CLASSE DI RESISTENZA CALCESTRUZZO

N/mm<sup>2</sup>

C32/40

SCHEDA N. POZ31

DATA 29/12/2011

MOD. S823M

REVISIONE

N° 0 DEL 07/12/2020

F.LLI VACIS srl Via Dante Alighieri, 13 24050 COVO BG

Tel 036393167 Fax 0363938688

www.vacissrl.it - info: vacissrl@vacissrl.it

